

ANVIZ



Distributed by:



2022

Access Control & Time and Attendance Solutions

ANVIZ

Anviz Global

32920 Alvarado-Niles Rd Ste 220, Union City, CA 94587 | Toll-free: 1-855-268-4948 | sales@anziv.com | www.anziv.com

©2022 Anviz Global Inc. All right reserved. Product specifications and availability are subject to change without notice. For the most up-to-date information, please visit www.anziv.com

Contents

| About Anviz

Leading Security Solution Provider for Commercial Market

| Face Recognition

AI Based Smart Face Recognition Terminals

| Outdoor Access

Outdoor Biometric & RFID Access Control

| CrossChex

Access Control & Cloud-based Time and Attendance Software

| Mobile Access

Secure & Convenient Touchless Access Control

| Time and Attendance

Biometric-based Time Attendance Management



About Anviz

Providing smart solutions based on cloud and IoT technologies to SMB and enterprises clients globally.

20 Years +
Experiences

100+
Countries

200,000+
Projects

200+
Intellectual Property

BioNANO
Core Algorithm

RVI™
Video Intelligence Analysis

Cloud
Anviz Open Cloud Platform

ACP™
Anviz Secure Control Protocol



Access Control & Time and Attendance Solutions



Intelligent Surveillance Products and Solutions



China Office

Global R&D Center & Operation Center



USA Office

Sales & Operation & Customer Service Center



Manufacturing Base

50,000 Square Meters
2,000,000 Units Capacity Annually

Anviz Milestones

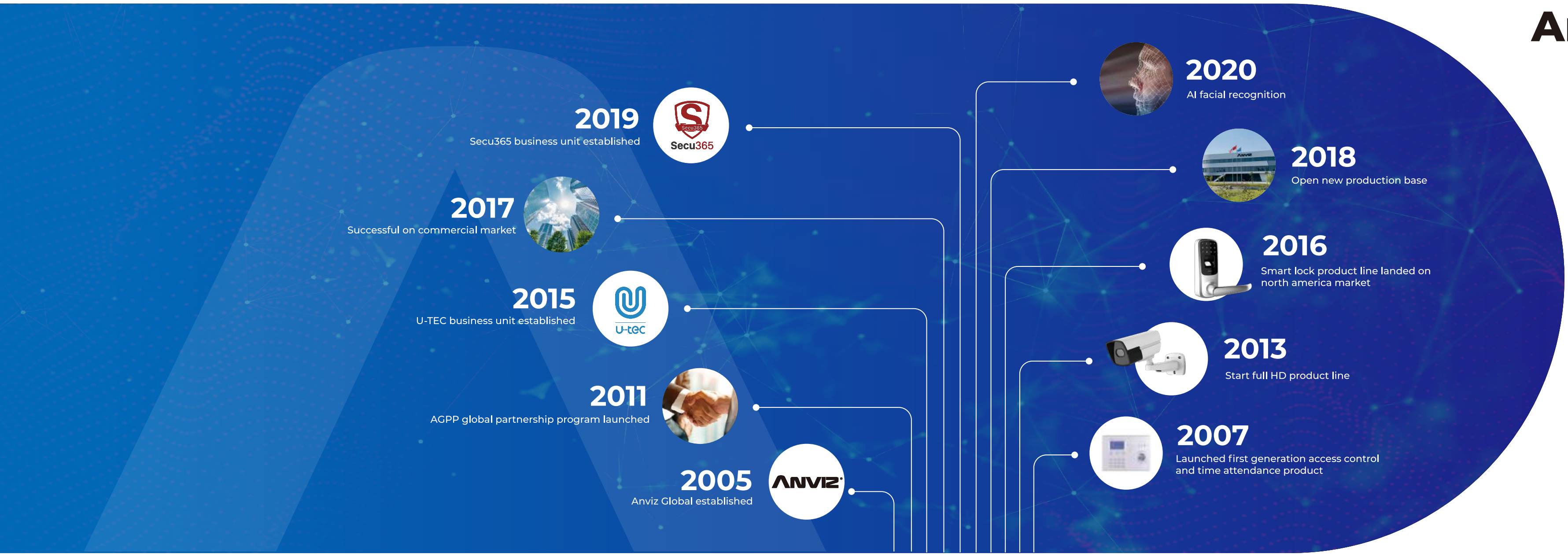

Technical Partner

- | | |
|--|--|
| | |
| | |
| | |
| | |
| | |
| | |
| | |

Anviz Core Technologies

Anviz values innovation, we invest most of our funds in the R&D department to stay at the top of the biometric access control, time and attendance, and surveillance industry. Anviz recruits professional developers around the world, and technical teams located in global offices to support our clients timely.

BioNANO® Patent Biometrics Algorithm

Fingerprint Algorithm

- Auto Adjust for Wet and Dry Finger
- FFD (World Best Fake Finger Detection)
- Securer Fingerprint Template Encryption
- Heal Broken Fingerprint Line

Face Algorithm

- Liveness Face Detection
- Global Face Detection Adoption
- Masked Face Detection
- Fast Forehead Positioning and Temperature Detection

Iris Algorithm

- Most Securer Comparison Way
- 1:1,000,000 Lowest False Rate
- Adopt for Complex Environment
- Two Eyes Accurate Identification



Patent Surveillance Algorithm Realtime Video Intelligence

Smart Imaging

- True WDR Technologies
- Startlight Imaging Priority
- Smart IR Technology
- Image Distortion Correction

AI Algorithms

- Person Detection
- Vehicles Detection
- Intruder Detection
- Crossline Detection

Smart Stream and Storage

- Auto Optimize Stream in Damic Area
- Auto Optimize Stream for ROI Area
- Three streams for Smart Usage
- Multiple Storage Options

Data Security

- End to End Data Encryption
- AWS Global Cloud Platform
- Login Verification
- AES256 & HTTPS Protection



Data Privacy & Security

Biometric Template Encryption

We use our own algorithm to encrypt the data into codes and we never restore any raw fingerprint, face or Iris image.

Personal Information on Card

We provide biometric information on card technologies, to restore the fingerprint, face templates on Mifare card and not restored in device, so ensure the privacy to use these biometrics information.

Personal Information on Mobile

We provide biometric information on mobile technologies, to restore the fingerprint, face templates on mobile phone and not restored in device, so ensure the privacy to use these biometrics information.

End to End Data Protection

All the data communication among edge device, local server, cloud server and APP are projected and encrypted by AES256 and HTTPS protocol to ensure the overall protection to follow the GDPR regulations.

Why Anviz?

Global Sales

4 Global Offices
300+ Employees
100+ Distributors
30+ Technical Partners
2000+ Resellers
50+ System Integrators

Canada

USA

South America

Project Registration Program

Anviz rewards you for specifying Anviz products in project bidding. We give our integrator partners the opportunity to strengthen their position on projects with special pricing and the full and active support of the Anviz team.

Europe

Shanghai

South East Asia

Africa

Success Stories



Mexico Government Liveness Fingerprint Access Control Project
100,000 staffs
1,000 sites



Top 20 Universities Cloud-based Time & Attendance Project
150,000 students and faculties



Total Security Solution for Global offices of A Corporate
50,000 staffs across more than **30** global branches

Global Events



Global Expo



Road Show



Training Webinar

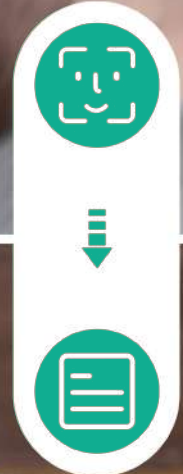

CrossChex

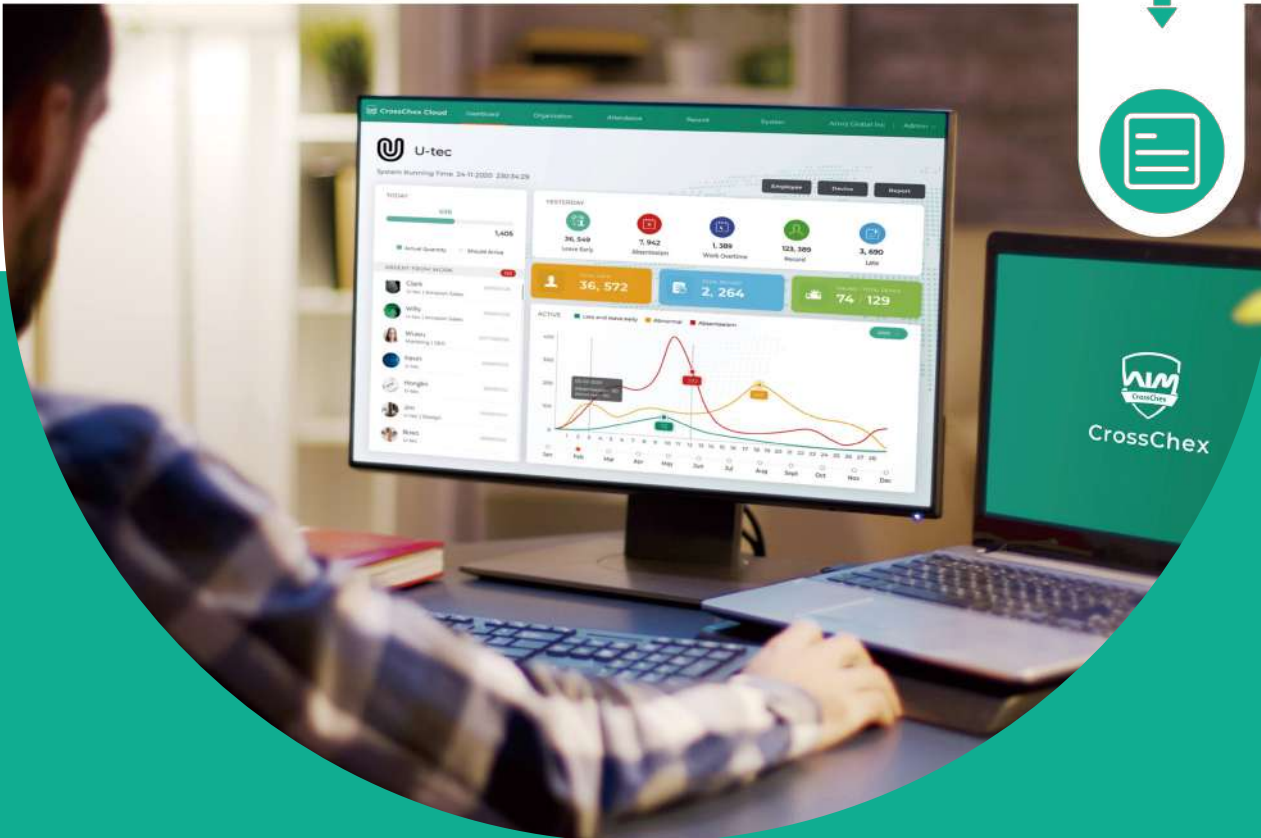

CrossChex Standard

Desktop Access Control & Time Attendance Software

CrossChex is a professional access control and time & attendance management solutions. With it's unique features and flexible and multiple system deployment structures, customer oriented concepts to satisfy SMB and enterprises clients for their time management, access control management requirements and help them improve the overall efficiency on HR and security management.

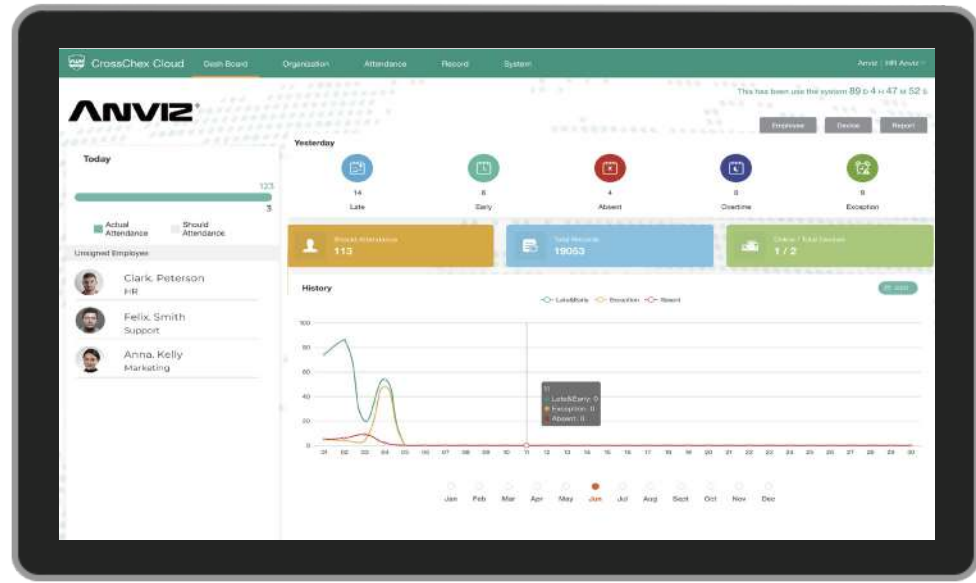

- Manage your time and attendance on cloud without any software.
- Access data anywhere, anytime, from any computer.
- Track employees from any location to see where employees clocked in and out.
- View reports of employees' attendance and health.
- Shift work times whenever you want.

High-Impact Reporting
Easily track and export employee hours in seconds which makes you feel intuitive with daily processes.

Powerful Dashboard
The handy dashboard lets you easy to track employee attendance by real-time analytics.

Best-in-Class Scheduling
Easily set up attendance rules, create and manage employee schedules for all your organization.

Super Easy Employees and Devices Management
Easy and quick to set up devices and add, delete, or modify employees' information.

CrossChex Cloud

Cloud-based Time & Attendance Management Solution

CrossChex Cloud is a super quick setup and easy to use system dedicated to saving your business money through employee time management works for any business.

- Scheduling
- Dashboard
- Reporting
- Management
- Mobile

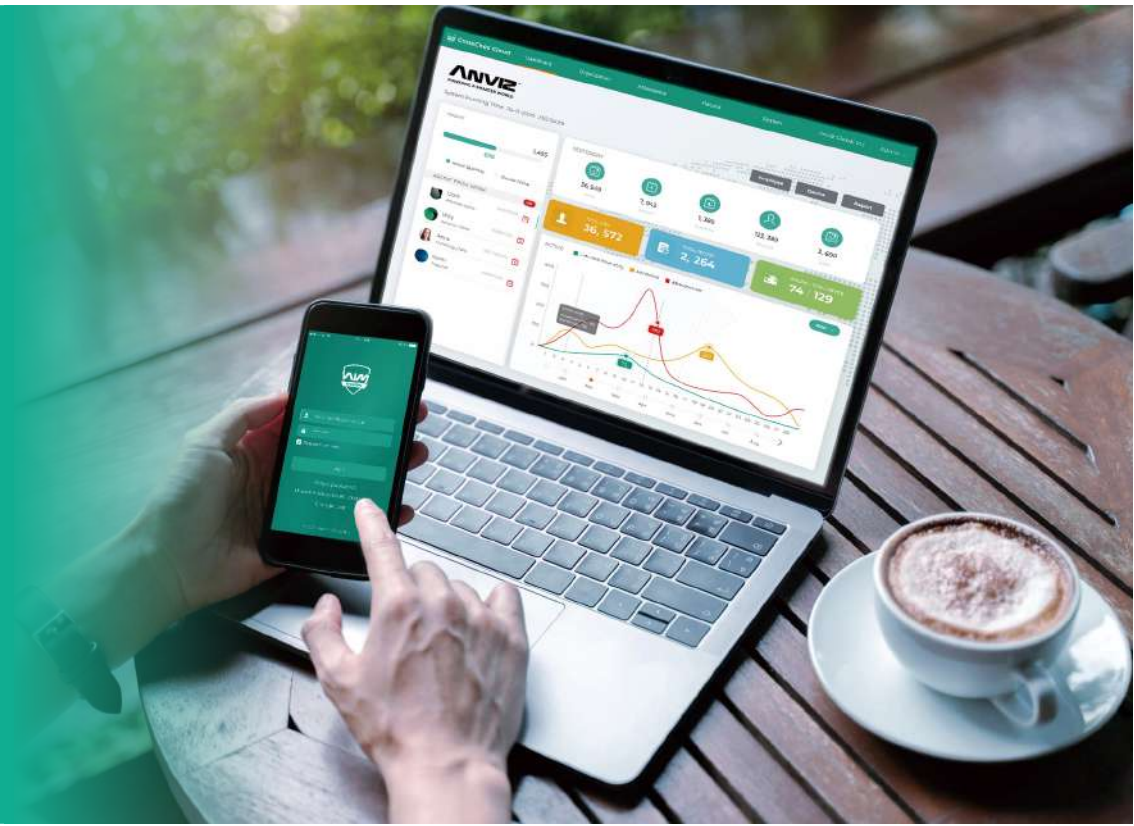



CrossChex Mobile

More Convenient More Secure

CrossChex Mobile is the mobile version of CrossChex Software, which lets you add and manage everyone and grant access rights to them on a smartphone. Your staff can easily clock in and access to any places with just one click on the phone. Any of Anviz access control devices with Bluetooth function can be added to CrossChex Mobile, and the time attendance device with Bluetooth function can be also added to CrossChex Mobile to have a clock in function and realize the access control function with linked to a Bluetooth micro access controller. CrossChex Mobile is suitable for the application in small offices, retail stores, gyms, clinics, etc.



For Users

- Use your phone to unlock doors.
- Employees can check in and out from the phone.
- No more lost, misplaced or shared cards.
- Check attendance record from your phone.



For Admins

- Use your phone to add and delete users/ fingers/ cards.
- Grant or revoke access to anyone with one click.
- Save cost of issuing cards and maintenance in comparison to physical cards.

Face Recognition

Today's dynamic business environment requires real-time time management and access control solution with anytime, anywhere access. Anviz's FaceDeep Series, a fully integrated contactless and thermal management face recognition solution for the people to access control of entrances or record attendance time and simultaneously check temperature and mask-wearing without having to touch a terminal or gate, requirements which are quickly finding their way into commercial offices, hospitality and retail chains, hopeful crowded sports arenas, medical facilities, and more.

- AI**
AI Deep Learning Engine
- Various Conditions**
- 3D Live Face Detection**
- Support Cloud**
- Temperature Screening**

Mounts



Auto Swing Door

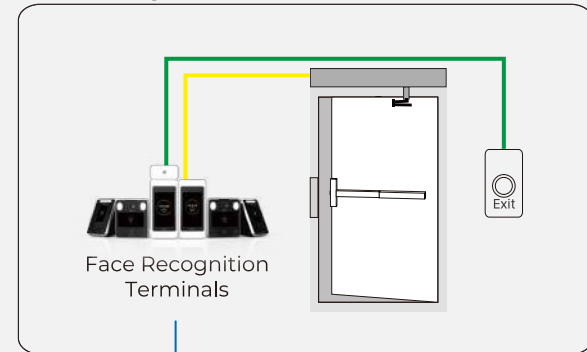

Auto Sliding Door

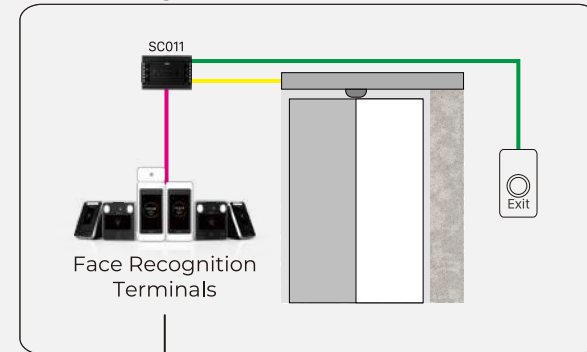

Time Clocking Point

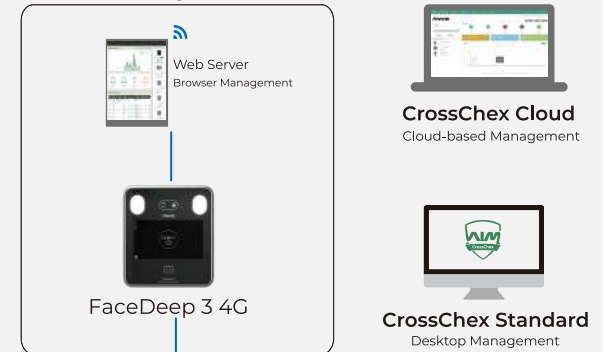

— Exit Button — Anviz Wiegand — Relay



FaceDeep 3 & FaceDeep 3 IRT



FacePass 7 Pro & FacePass 7 Pro IRT









FaceDeep 5 & FaceDeep 5 IRT



FaceDeep 3 QR & FaceDeep 3 IRT QR

Specification Comparison

Product	 NEW	 NEW	
Product Name	W3	FacePass 7 Pro	FaceDeep 5
Face Templates Capacity	200	3,000	50,000
Log Capacity	50K	100K	100K
LCD	2.8" TFT	3.5" TFT Touchscreen	5.0 TFT Touchscreen
Verify Speed (1:3000)	<1.0s	<0.3s	<0.2s
Live / Fake Detection	✓	✓	✓
Mask Detection	✓	✓	✓
Identify Distance	0.3~1.0m (0.39~0.79")	0.3~1.3m (1.18~51.18")	0.3~2.0m (1.18~19.69")
Temperature Detection	-	FacePass 7 Pro IRT: Body Temperature Detection	FaceDeep 5 IRT: Body Temperature Detection
Body Temperature Detection Distance	-	30~50cm (11.81~0.79")	30~50cm (11.81~0.79")
RFID Options	125kHz EM	FacePass 7 Pro: 125kHz EM FacePass 7 Pro IRT: 125kHz EM FacePass 7 Pro-MIF: 13.56MHz MIFARE FacePass 7 Pro IRT-MIF: 13.56MHz MIFARE	125kHz EM & 13.56MHz MIFARE
QR Code Scanning Distance	-	-	-
Batch Enrollment	-	✓	✓
TCP/IP	✓	✓	✓
Wi-Fi	Optional	✓	✓
RS485	-	✓	-
Bluetooth	-	-	-
USB Host	-	✓	✓
Internal Relay (Door Control)	✓	✓	✓
Exit Button	✓	✓	✓
Door Contact	✓	✓	✓
Wiegand Output	-	✓	✓
Wiegand Input	✓	✓	✓
Tamper Switch	✓	✓	✓
Environments	Indoor	Indoor	IP65 / Outdoor
Software	CrossChex Standard & CrossChex Cloud	CrossChex Standard & CrossChex Cloud	CrossChex Standard & CrossChex Cloud

			 NEW
FaceDeep 3	FaceDeep 3 Pro	FaceDeep 3 4G	FaceDeep 3 QR
6,000	6,000(Standard), 10,000(Customized)	6,000(Standard), 10,000(Customized)	6,000
100K	100K	100K	100K
5.0 TFT Touchscreen	5.0 TFT Touchscreen	5.0 TFT Touchscreen	5.0 TFT Touchscreen
<0.3s	<0.3s	<0.3s	<0.3s
✓	✓	✓	✓
✓	✓	✓	✓
0.3~1.5m (11.81~59.06")	0.3~1.5m (11.81~59.06")	0.3~1.5m (11.81~59.06")	0.3~1.5m (11.81~59.06")
FaceDeep 3 IRT: Body Temperature Detection	FaceDeep 3 Pro IRT: Body Temperature Detection	FaceDeep 3 4G IRT: Body Temperature Detection	FaceDeep 3 IRT QR: Body Temperature Detection
1~2cm (0.39~0.79")	1~2cm (0.39~0.79")	1~2cm (0.39~0.79")	1~2cm (0.39~0.79")
125kHz EM	13.56MHz MIFARE	13.56MHz MIFARE	-
-	-	-	3~10cm (1.18~3.94")
✓	✓	✓	✓
✓	✓	✓	✓
✓	✓	✓	✓
✓	✓	✓	✓
✓	✓	✓	✓
✓	✓	✓	✓
✓	✓	✓	✓
✓	✓	✓	✓
✓	✓	✓	✓
✓	✓	✓	✓
✓	✓	✓	✓
✓	✓	✓	✓
-	✓	✓	-
✓	✓	✓	✓
Indoor	Indoor	Indoor	Indoor
CrossChex Standard & CrossChex Cloud	CrossChex Standard & CrossChex Cloud	CrossChex Standard & CrossChex Cloud	CrossChex Standard & CrossChex Cloud

Access Control

Outdoor Access

M Series standalone access control devices is suitable for various outdoor environment, with its professional IP65 and IK10 design. M series is integrated with fingerprint and keypad touchable and RFID card, NFC and optional Bluetooth touchless identification ways. M series can be applied into direct and distributed door controlling, wiegand output to third party controller, and also can in integrated with turnstiles, outdoor consumer terminals, etc.

 **Metal Housing IK10 Vandal-proof Structure**

Come with robust, vandal-resistant metal housing and sophisticated engineering, it's able to withstand a high level of impact, making it vandal-resistant.

 **IP65 Dust & Water Proof**

Anviz M Series is a perfect solution for outdoor applications coupled with IP65 ingress protection.

 **Versatile Access Control Interfaces**

M Series comes with full TCP/IP, RS-485 and Wiegand interfaces to provide higher flexibility and multiple installation options for different environments. It offers an exit button and door sensor inputs and 1 relay output to control peripheral devices

 **Mobile Access**

Easily access any place with just one click on the phone.

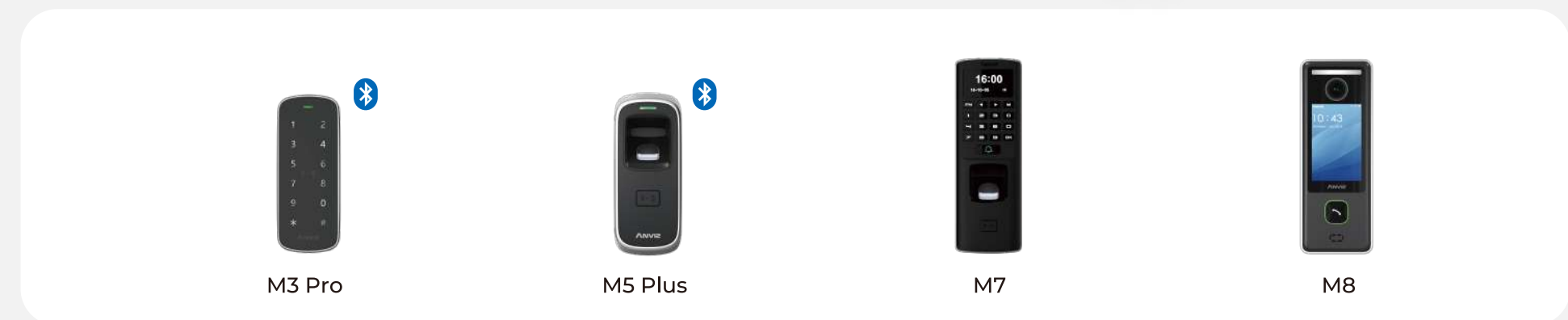
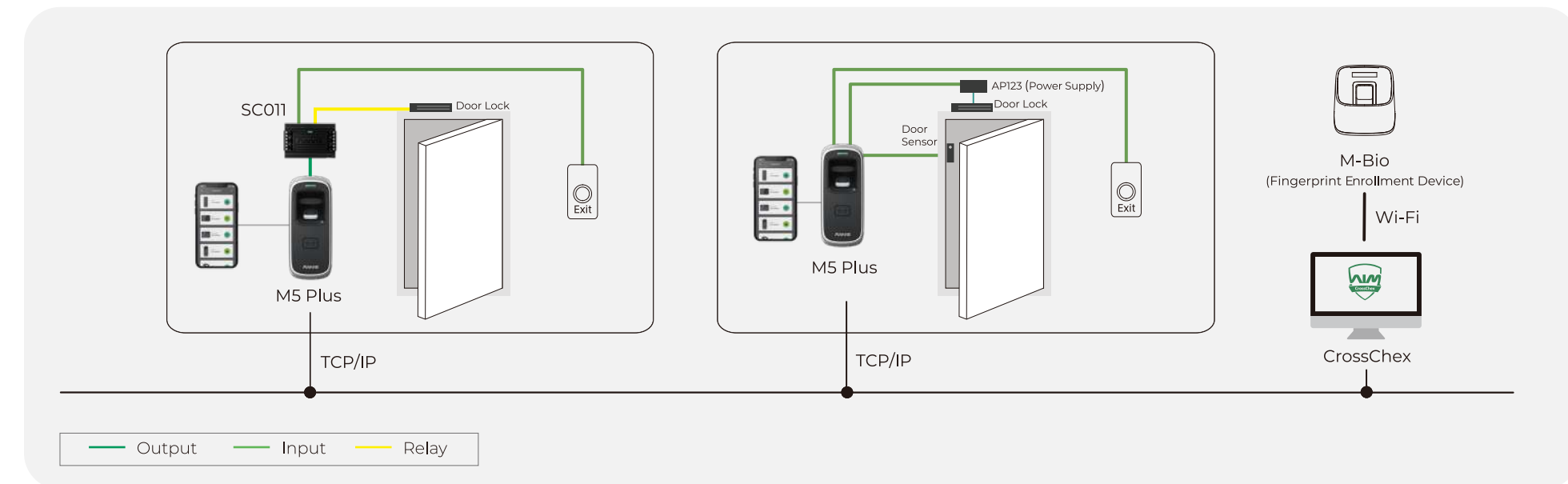

Specification Comparison

					 * 
Product		M3 Pro	M5 Plus	M7	M8
Product Name		M3 Pro	M5 Plus	M7	M8
Identification Mode		Password, Card	Finger, Card	Finger, Password, Card	Face, Password, Card
RFID Options		125KHz EM & 13.56MHz MIFARE	125KHz EM(Standard), 13.56MHz MIFARE(Optional)	125KHz EM & 13.56MHz MIFARE	125KHz EM(Standard), 13.56MHz MIFARE(Optional)
Max. Users		10,000	3,000	3,000	1,000
Max. Cards		10,000	3,000	3,000	1,000
Max. Logs		100,000	50,000	50,000	100,000
Group, Time Zone		16 groups, 32 time zones	16 groups, 32 time zones	16 groups, 32 time zones	16 groups, 32 time zones
Web Server		✓	✓	-	✓
Voice Prompt		Buzzer	Buzzer	Buzzer	Voice
Multiple Language		-	-	✓	✓
Software		CrossChex Standard	CrossChex Standard	CrossChex Standard	CrossChex Standard & CrossChex Cloud
CPU		Linux 1.0 GHz	Linux 1.0 GHz	32-bit Processor	Linux 1.0 GHz
Sensor		-	AFOS Touch Active Sensor	AFOS Touch Active Sensor	Camera
Scanning Area		-	22mmx18mm (0.87x0.71")	22mmx18mm (0.87x0.71")	-
Display		-	-	1.28 OLED Screen	4.3" TFT
Keypad		Touch Active	-	Physical Button	Touch Active
Dimensions(W x H x D)		124x47x22mm (4.88x1.85x0.87")	50x124x34.5mm (1.97x4.88x1.36")	58x166x32mm (2.28x6.54x1.26")	124x47x22mm (4.88x1.85x0.87")
Working Temperature		-30°C~60°C (-22°F~140°F)	-30°C~60°C (-22°F~140°F)	-30°C~60°C (-22°F~140°F)	-10°C~60°C (14°F~140°F)
Humidity		20% to 90%	20% to 90%	20% to 90%	20% to 90%
PoE		-	-	IEEE802.3af/at	IEEE802.3af/at
Power Input		DC12V	DC12V	DC12V	DC12V
Protection Class		IP65, IK10	IP65, IK10	IP65, IK10	IP65
TCP/IP		✓	✓	✓	✓
RS485		✓	✓	✓	✓
Wi-Fi		✓	✓	-	✓
Bluetooth		✓	✓	-	Optional
Relay		✓	✓	✓	✓
I/O		Door Contact/ Exit Button	Door Contact/ Exit Button	Door Contact/ Exit Button	Door Contact/ Exit Button
Tamper Alarm		✓	✓	✓	✓
Anti-pass Back		-	✓	-	-
Wiegand		Output	Output	Output	Output

*M8 Intercom version is scheduled to be released in the second half of 2022.

Access Control

C2 Series

Versatile Standalone Access & Time Attendance Control Terminal



Multi-Smartcard Reader

Support 125kHz or 13.56MHz RFID including MIFARE, MIFARE Plus, DESFire, FeliCa, LEGIC, EM, and NFC.



Communicates with Smartphones

With Anviz Control Protocol (ACP). Any data exchange between the terminal and the smartphone is heavily encrypted and eliminating the possibility of data hacking.



Mullion-type Design

C2 Series mounts easily with a small access control terminal that can easily be installed on a door frame.



IP65 Dust & Water Proof

C2 Series is designed to be used indoor and outdoor applications coupled with IP65 ingress protection.



PoE Easy Installation

Support power sourcing over Ethernet cable compliance to IEEE802.3af standard, to provide users with lower installation cost, simpler cabling, and lower maintenance cost.



Development Tools

We provide value-added integrations with Anviz new V2.0 SDK and API and offer support services to technology partners with full TCP/IP communication mode and the new C language is compiled into a dynamic library, which is compatible with various operations.

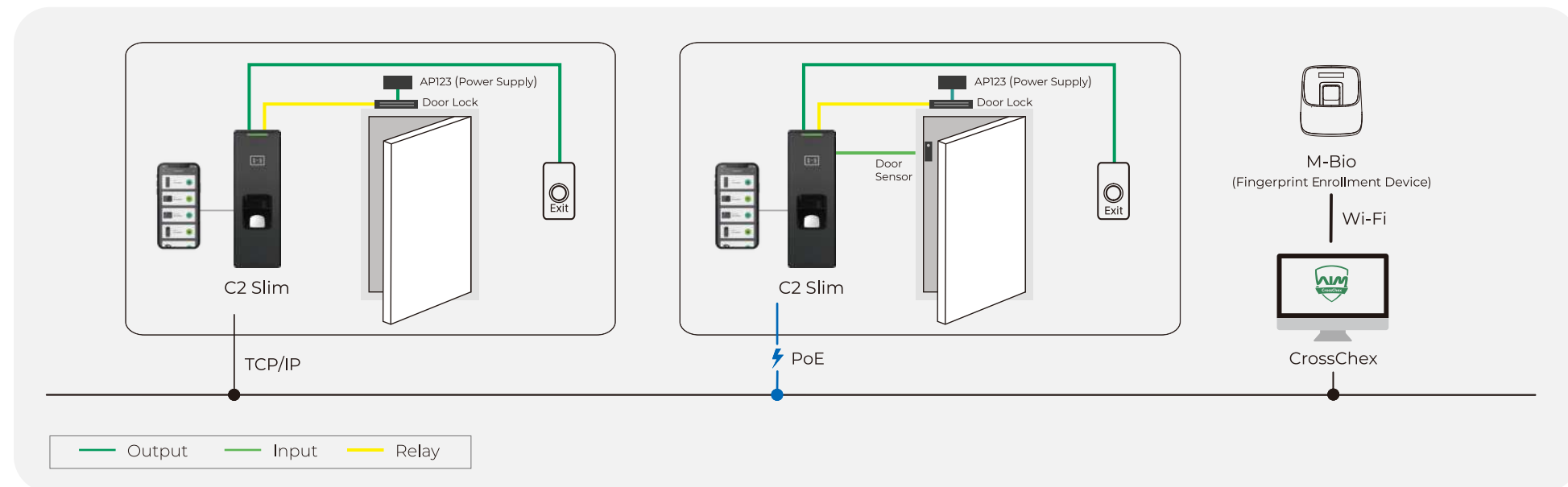

M-Bio
(Fingerprint Enrollment Device)

Wi-Fi



CrossChex



C2 SR



C2 KA







C2 Slim



C2 Pro
TA

Specification Comparison

Product					
Product Name		C2 SR	C2 KA	C2 Slim	C2 Pro
General	Identification Mode	Card	Card, Password	Finger, Card	Finger, Password, Card
	RFID Options	125kHz EM & 13.56MHz MIFARE	125kHz EM & 13.56MHz MIFARE	125kHz EM & 13.56MHz MIFARE Card HID iCalss(Optional)	125kHz EM & 13.56MHz MIFARE Card HID iCalss(Optional)
	Max. Users	-	10,000	3,000	10,000
Capacity	Max. Cards	-	10,000	3,000	10,000
	Max. Logs	-	100,000	50,000	100,000
	Time Attendance Mode	-	-	-	8
Function	Group, Time Zone	-	16 groups, 32 time zones	16 groups, 32 time zones	16 groups, 32 time zones
	Work Code	-	-	-	8 digits
	Short Message	-	-	-	50
	WebServer	-	✓	✓	✓
	Record Auto Inquiry	-	-	-	✓
	Daylight Saving	-	✓	✓	✓
	Voice Prompt	-	Voice	Voice	Voice
	Multiple Language	-	-	-	✓
	Software	-	CrossChex Standard	CrossChex Standard	CrossChex Standard & CrossChex Cloud
	CPU	32-bit Processor	Linux 1.0 GHz	Linux 1.0 GHz	Dual Core 1.0 GHz
Hardware	Sensor	-	-	AFOS Touch Active Sensor	AFOS Touch Active Sensor
	Scanning Area	-	-	22mmx18mm (0.87x0.71")	22mmx18mm (0.87x0.71")
	Display	-	-	-	3.5" TFT
	Keypad	-	Physical Button	-	Physical Button
	Dimensions(W x H x D)	50x159x25mm (1.97x6.26x0.98")	50x159x25mm (1.97x6.26x0.98")	50x159x25mm (1.97x6.26x0.98")	140x190x32mm (5.51x7.48x1.26")
	Working Temperature	-10°C~-60°C (14°F~-140°F)	-10°C~-60°C (14°F~-140°F)	-10°C~-60°C (14°F~-140°F)	-10°C~-60°C (14°F~-140°F)
	Humidity	20% to 80%	20% to 90%	20% to 90%	0% to 90%
	PoE	-	IEEE802.3af/at	IEEE802.3af/at	IEEE802.3af/at
	Power Input	DC12V	DC12V	DC12V	DC12V
	IP Grade	IP65	IP65	IP65	-
I/O	TCP/IP	-	✓	✓	✓
	RS232	-	-	-	✓
	RS485	✓	✓	✓	✓
	USB Host	-	-	-	✓
	Wi-Fi	-	✓	✓	✓
	Bluetooth	-	✓	✓	-
	Relay	-	✓	✓	✓
	I/O	-	Door Contact/ Exit Button	Door Contact/ Exit Button	-
	Tamper Alarm	-	✓	✓	-
	Wiegand	Output	IN & OUT	IN & OUT	Output

Time and Attendance

Anviz time and attendance solution provide a simple way to track and manage employee attendance, dedicated to saving your business money through employee time management, reducing administrative costs of time and attendance data collection and processing, thereby increasing overall productivity and profitability.



Biometric-based time and attendance management (Facial, fingerprint scanner, RFID and PIN) offer versatile punching options, provides accurate employee data that eliminates buddy punching and time theft, while also saving you money.



Flexible, scalable, and customizable schedule management to suit any business, no matter what size.









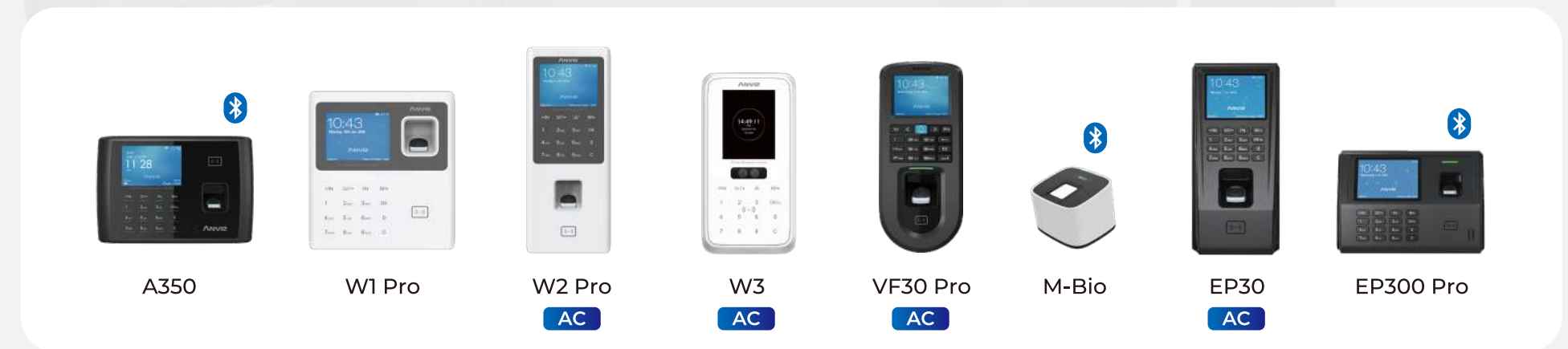
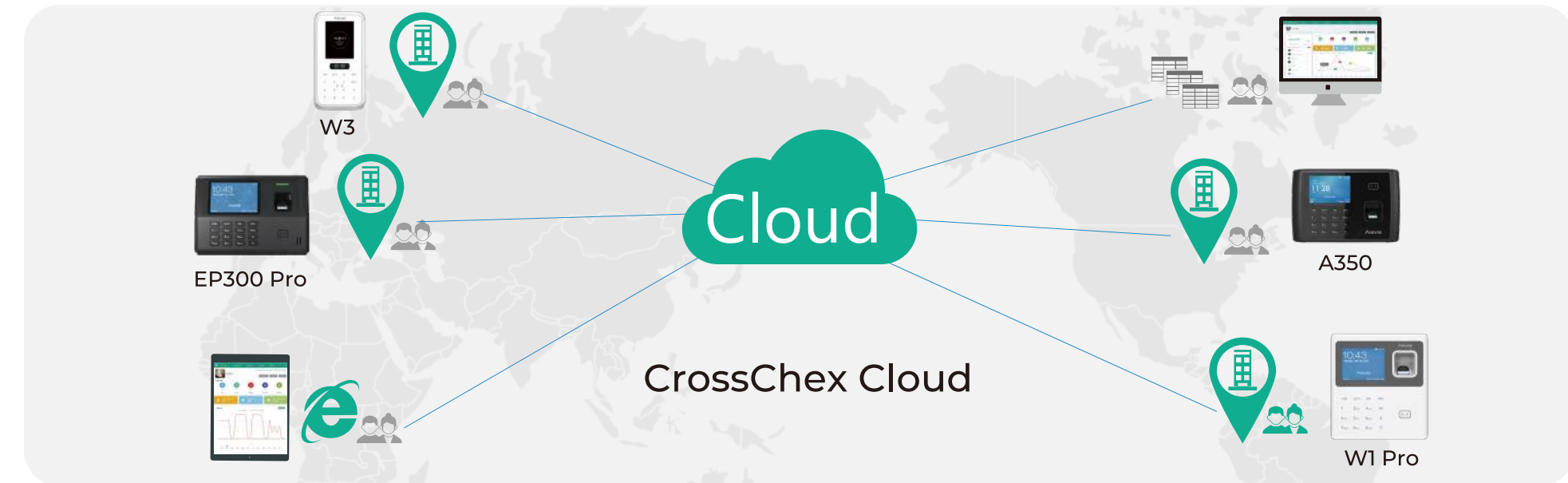
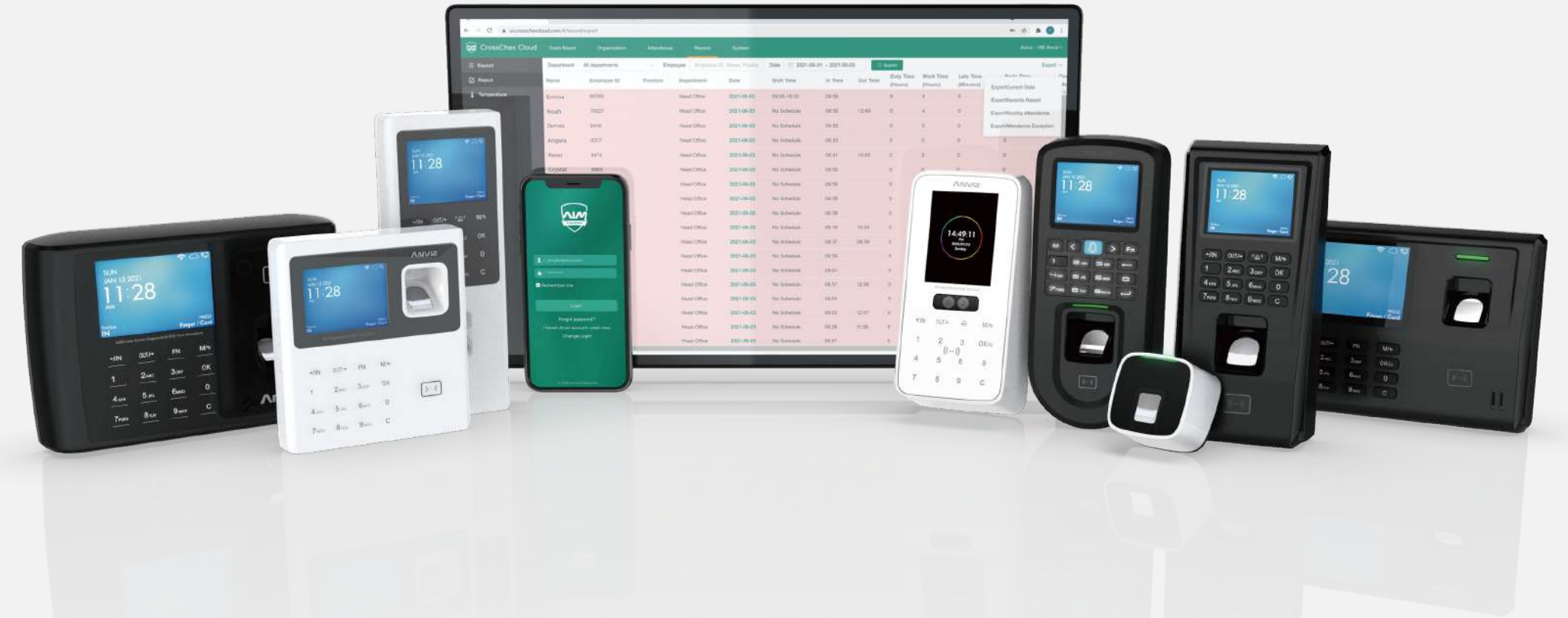

High-impact and personalized reporting which makes you feel intuitive with daily processes.



Time and attendance cloud support provide hassle-free workforce management, easily track and manage employee attendance from anywhere, anytime.



Specification Comparison

Product									
Product Name		W1C Pro W1 Pro	W2 Pro	W3	A350 Series	EP300 Pro	EP30	VF30 Pro	M-Bio
General	Identification Mode	Finger(W1 Pro), Password, Card	Finger, Password, Card	Face, Password, Card	Finger(A350 & A350 4G), Password, Card	Finger, Password, Card	Finger, Password, Card	Finger, Password, Card	Finger, Card
	RFID Options	125kHz EM	125kHz EM	125kHz EM	125kHz EM & 13.56MHz MIFARE	Model# EP300 Pro: 125kHz EM Model# EP300 Pro WiFi: 125kHz EM Model# EP300 Pro MAX: 125kHz EM	125kHz EM	Model# VF30 Pro: 125kHz EM Model# VF30 Pro MIF: 13.56MHz MIFARE	125kHz EM & 13.56MHz MIFARE
	Max. Users	3,000	3,000	200	3,000	3,000	3,000	3,000	3,000
Capacity	Max. Cards	3,000	3,000	200	3,000	3,000	3,000	3,000	3,000
	Max. Logs	100,000	100,000	50,000	100,000	100,000	100,000	100,000	100,000
	Time Attendance Mode	8	8	8	8	8	8	8	-
Function	Group, Time Zone	-	16 groups, 32 time zones	-	-	-	16 groups, 32 time zones	16 groups, 32 time zones	-
	Work Code	6 digits	6 digits	-	6 digits	6 digits	6 digits	6 digits	-
	WebServer	✓	✓	✓	✓	✓	✓	✓	✓
	Record Auto Inquiry	✓	✓	✓	✓	✓	✓	✓	-
	Daylight Saving	✓	✓	✓	✓	✓	✓	✓	-
	Voice Prompt	Voice	Voice	Voice	Voice	Voice	Voice	Voice	Voice
	Multiple Language	✓	✓	✓	✓	✓	✓	✓	-
	Software	CrossChex Standard & CrossChex Cloud	CrossChex Standard & CrossChex Cloud	CrossChex Standard & CrossChex Cloud	CrossChex Standard & CrossChex Cloud	CrossChex Standard & CrossChex Cloud	CrossChex Standard & CrossChex Cloud	CrossChex Standard & CrossChex Cloud	CrossChex Standard & CrossChex Cloud
	Sensor	AFOS Touch Active Sensor	AFOS Touch Active Sensor	Dual Cameras	AFOS Touch Active Sensor	AFOS Touch Active Sensor	AFOS Touch Active Sensor	AFOS Touch Active Sensor	AFOS Touch Active Sensor
	Display	2.8' TFT LCD	2.8' TFT LCD	2.8' TFT LCD	2.8' TFT LCD	3.5' TFT LCD	3.5' TFT LCD	2.4' TFT LCD	1.18' OLED
Hardware	Keypad	Touch Active	Touch Active	Touch Active	Touch Active	Physical Button	Physical Button	Physical Button	-
	Dimensions(W x H x D)	130x140x30mm (5.11x5.51x1.18")	204x80x30mm (8.03x3.15x1.18")	105x72x46mm (4.13x2.83x1.81")	204x139x38mm (5.11x5.51x1.18")	185x130x35mm (7.28x5.12x1.38")	165x76x35mm (6.50x2.99x1.38")	80x180x40mm (3.15x7.09x1.57")	60x60x50mm (2.36x2.36x1.97")
	Working Temperature	-10°C~60°C (14°F~140°F)	-10°C~60°C (14°F~140°F)	-10°C~60°C (14°F~140°F)	-10°C~60°C (14°F~140°F)	-10°C~60°C (14°F~140°F)	-10°C~60°C (14°F~140°F)	-10°C~60°C (14°F~140°F)	-10°C~60°C (14°F~140°F)
	Humidity	20% to 90%	20% to 90%	20% to 90%	10% to 90%	20% to 90%	20% to 90%	20% to 90%	20% to 90%
	Power Input	DC12V	DC12V	DC12V	DC5V	DC5V	DC12V	DC12V & PoE IEEE802.3af/at	USB
	Battery	-	-	-	-	Model# EP300 Pro MAX	-	-	✓
	TCP/IP	✓	✓	✓	✓	✓	✓	✓	-
I/O	RS485	-	✓	-	-	-	✓	✓	-
	USB Host	✓	✓	✓	✓	✓	-	-	-
	Wi-Fi	✓	✓	✓	✓	Model# EP300 Pro WiFi Model# EP300 Pro MAX	✓	✓	✓
	Bluetooth	-	-	-	✓	Model# EP300 Pro WiFi Model# EP300 Pro MAX	-	-	✓
	4G	-	-	-	Model# A350 4G Model# A350C 4G	-	-	-	-
	Relay	-	✓	✓	✓	-	✓	✓	-
	I/O	-	Door Contact/ Exit Button /Bell	Door Contact/ Exit Button /Bell	-	-	Door Contact/ Exit Button	Door Contact/ Exit Button /Bell	-
	Tamper Alarm	-	✓	-	-	-	✓	✓	-
	Anti-pass back	-	✓	-	-	-	✓	✓	-
	Wiegand	-	IN & OUT	-	-	-	Output	IN & OUT	-